

Modular design for rapid change

The design of the Galaxy range of probes allows the operator to rapidly switch any component of the assembly as required. Encircling coils within the same size range can be exchanged in a matter of seconds to suit manufactured product variation.

Coil holders are available in 4 sizes that can house the full range of coils for product of less than 1mm up to 500mm in diameter (see table for sizes).



One Tool Toolkit

The whole system is assembled using an allen key allowing a simple and rapid way of modifying equipment setup. This means there is no requirement for special tools, and only simple personnel training is required for maintenance operations.

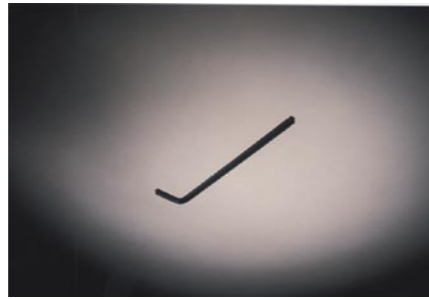

Allen key for simple set-up

Low Cost of ownership

A unique aspect of the Galaxy range is the rapidly interchangeable guides. This allows guides in a wide range of materials for specific handling of different products.

This approach means that the unit can be extremely cost effective over its lifetime due to the low cost of consumables, and it is extremely flexible for inspecting a wide range of product.



Range of interchangeable guides

Precise Eddy Current performance

At the heart of the system lies the Hocking Eddy Current coil. Manufactured to exacting standards it delivers superb signal to noise ratio and again is a modular component that can be replaced as required by the operator without disposing of the entire assembly.

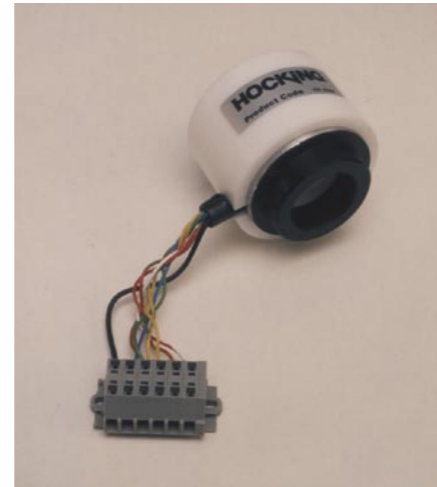

Replaceable Eddy Current coil

Galaxy Encircling Coils External Diameter Tube Inspection



In-Line and off-line high speed inspection of tube, wire, bar etc.
Highly cost-effective and flexible
Rapid change for product size variation
Choice of hard or soft product guides
User machinable guides
Suits circular and non-circular products



Coil and Holder Dimensions

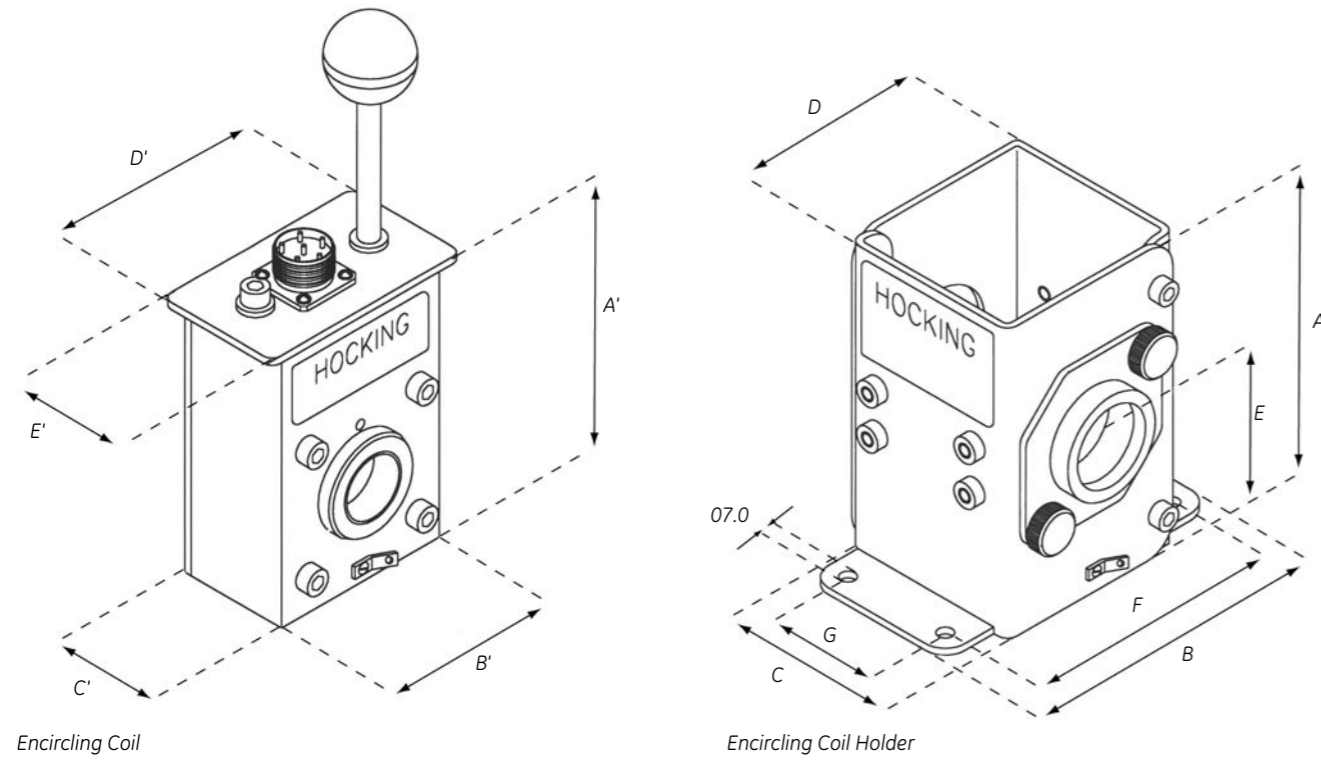

Encircling Coil Dimensions

	Size 1	Size 2	Size 3	Size 4
Aperture range (mm)	1 to 26	20 to 51	40 to 77	60 to 102
A'	115	140	TBA	TBA
B'	75	106	TBA	TBA
C'	46	46	TBA	TBA
D'	90	120	TBA	TBA
E'	52	52	TBA	TBA

Encircling Coil Holder Dimensions

	Size 1	Size 2	Size 3	Size 4
Aperture range (mm)	1 to 26	20 to 51	40 to 77	60 to 102
A	138	163	TBA	TBA
B	139	169	TBA	TBA
C	84	84	TBA	TBA
D	85	119	TBA	TBA
E	69	84	TBA	TBA
F	119	149	TBA	TBA
G	50	50	TBA	TBA

Components of a Galaxy System

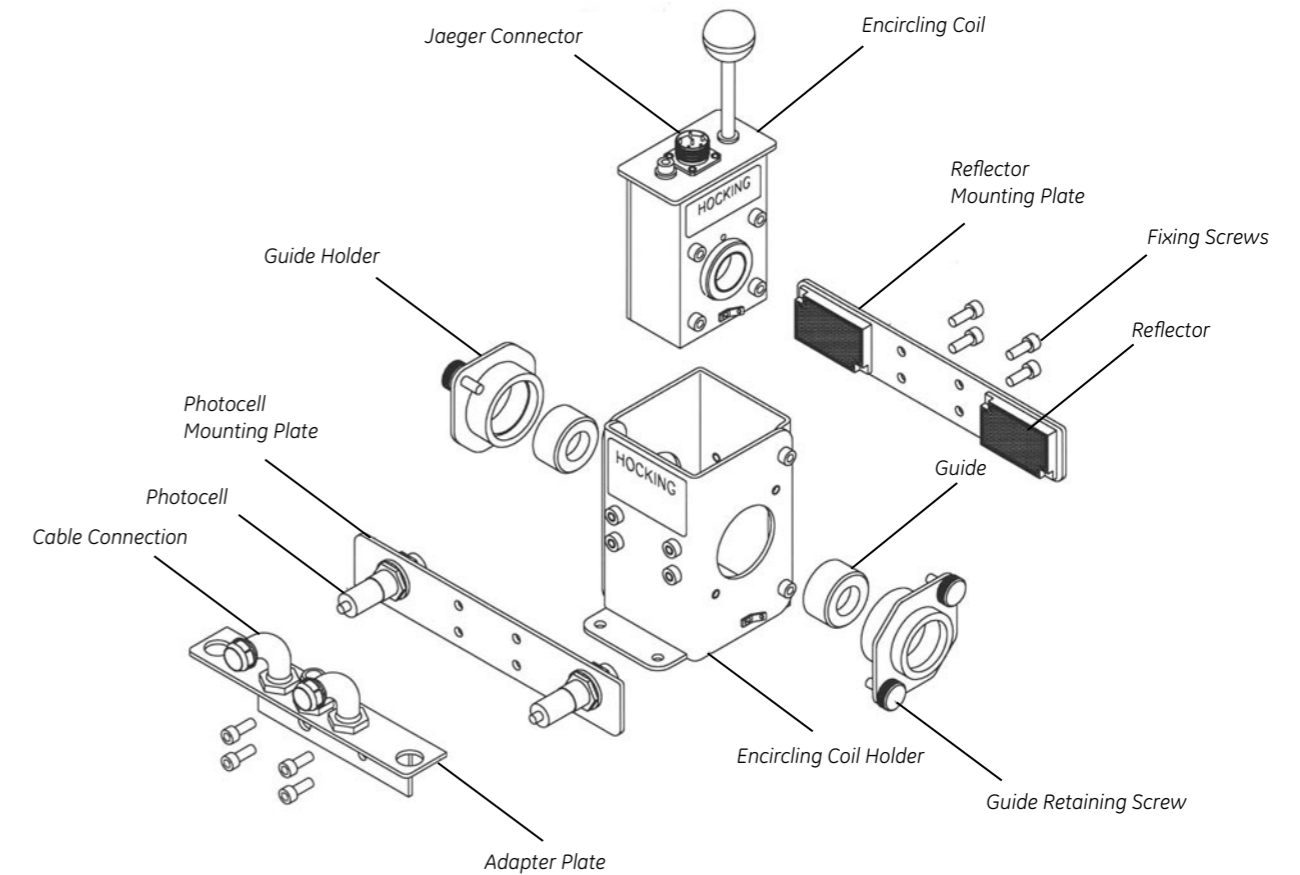

Components of this system may be ordered individually.

The diagram illustrates all the components that might be assembled to form a system.

Name	PRN	Notes
Encircling Coil	GAL1CCNNN	NNN indicates the size in millimetres required for the coil aperture. e.g. if a 26mm ID was required for the coil the PRN would be GAL1CC026.
Jaeger Connector	N/A	The six way Jaeger connector is standard for all Galaxy coils. This is a standard part of the Encircling Coil above.
Encircling Coil Holder	GAL1H	One coil holder will take all coils from that size range. e.g. for a GAL2 series coil a GAL2H holder would be required.
Guide	GAL1GNNN	As for the encircling coil above NNN indicates the size in millimetres required for the product. These can be ordered in a range of materials such as Nylon or Stainless Steel in order to suit the product handling requirements.
Guide Holder	N/A	Quick release plates that hold the guides in position.
Guide retaining screw	N/A	Part of the guide assembly that allows quick exchange of guides.
PhotoCell Assembly	N/A	For detection of start and end of product entering and leaving the coil. Comprises two photo-cells, photocell mounting plate, two reflectors and reflector mounting plate.
Cable Management	N/A	Allows tidy management of all leads associated with the coil assembly. Comprises cable connection conduit, adapter plate and cable trunking as required.